

Varioflexleitungen mit TÜV

Varioflex lines

Durites des freins renforcées, système Varioflex

Varioflexleitungen mit Teilegutachten

- einschraubbare Anschlüsse aus Aluminium in sechs verschiedenen Farben
- verschiedene Anschlüsse in Edelstahl lieferbar
- hohe Flexibilität in der Lagerhaltung
- deutliche Verbesserung des Druckpunktes
- aussagefähige Montageanleitung
- Leitungen transparent oder schwarz ummantelt
- Leitungen nach FMVSS 106 gefertigt
- Teflon Innenseele, außen vierfadiges Stahlgewebe

Varioflex lines

- threaded alloy connections available in 6 different colors
- several connections are available in stainless steel
- increase stocking flexibility
- marked improvement of the pressure point
- informative fitting instruction
- protective transparent or black plastic sleeve
- varioflex lines comply with standard FMVSS 106
- teflon core, four-thread braided steel covering

Durites de freins renforcées, système varioflex

- raccords filetés en aluminium, disponibles en 6 couleurs différentes
- différents raccords sont disponibles en acier
- permet une grande flexibilité en terme de stockage
- amélioration sensible du point de pression
- instructions de montage détaillées
- recouverts d'une couche protectrice noire ou transparente
- conduits réalisés selon la norme FMVSS 106
- durite téflon, renforcée par une tresse 4 branches en acier



**Varioflex
mit TÜV-
Gutachten!**

**Zur Komplettierung einer Bremsleitung
bitte Anschlüsse, Leitungen und Dichtringe
separat bestellen!**

*To complete the brake line, please order
lines, connectors and seals separately!*

*Pour réaliser un kit durite, merci de
commander les raccords, les durites
et les joints au-dessus!*



**Verdrehbare
Anschlüsse!**

*Twistable
connections!*

*Raccordements
souples!*



Verpresste Stahlflexleitungen mit individuell einschraubbaren Fittingen

Pressed steel flex lines with screw-in fittings, length overview

Durite acier avec sertissage des écrous extérieurs par longueur

T = transparent ummantelt

T = clear covering

T = gaine de protection transparente

S = schwarz ummantelt

S = black covering

S = gaine de protection noire



13 cm	MV 013T/S
15 cm	MV 015T/S
18 cm	MV 018T/S
21 cm	MV 021T/S
23 cm	MV 023T/S
25 cm	MV 025T/S
27 cm	MV 027T/S
29 cm	MV 029T/S
31 cm	MV 031T/S
33 cm	MV 033T/S
35 cm	MV 035T/S
37 cm	MV 037T/S
39 cm	MV 039T/S
41 cm	MV 041T/S
43 cm	MV 043T/S
45 cm	MV 045T/S
47 cm	MV 047T/S
49 cm	MV 049T/S
51 cm	MV 051T/S
53 cm	MV 053T/S
55 cm	MV 055T/S
57 cm	MV 057T/S
60 cm	MV 060T/S
63 cm	MV 063T/S
66 cm	MV 066T/S
69 cm	MV 069T/S
72 cm	MV 072T/S
75 cm	MV 075T/S
78 cm	MV 078T/S
81 cm	MV 081T/S
84 cm	MV 084T/S
87 cm	MV 087T/S
90 cm	MV 090T/S
93 cm	MV 093T/S
96 cm	MV 096T/S
99 cm	MV 099T/S
102 cm	MV 102T/S
105 cm	MV 105T/S
108 cm	MV 108T/S
110 cm	MV 110T/S
113 cm	MV 113T/S
115 cm	MV 115T/S
118 cm	MV 118T/S
120 cm	MV 120T/S
123 cm	MV 123T/S
126 cm	MV 126T/S
129 cm	MV 129T/S
131 cm	MV 131T/S
134 cm	MV 134T/S
137 cm	MV 137T/S
140 cm	MV 140T/S
143 cm	MV 143T/S
146 cm	MV 146T/S
149 cm	MV 149T/S
152 cm	MV 152T/S
155 cm	MV 155T/S
158 cm	MV 158T/S
161 cm	MV 161T/S
165 cm	MV 165T/S
167 cm	MV 167T/S
170 cm	MV 170T/S
174 cm	MV 174T/S
177 cm	MV 177T/S
181 cm	MV 181T/S
185 cm	MV 185T/S
189 cm	MV 189T/S
193 cm	MV 193T/S
197 cm	MV 197T/S
200 cm	MV 200T/S

Anschlüsse Varioflexleitungen

Connectors Varioflex lines

Raccords pour système Varioflex

MV 10A00

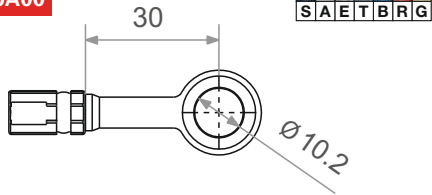

MV 11A00

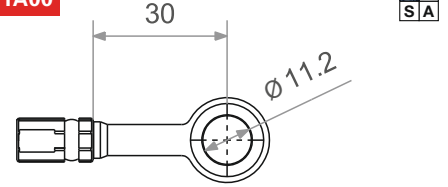

MV 10B20

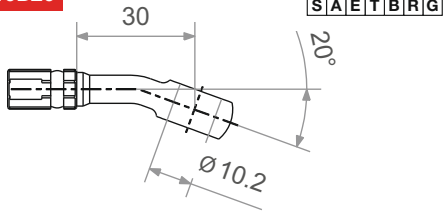

MV 11B20

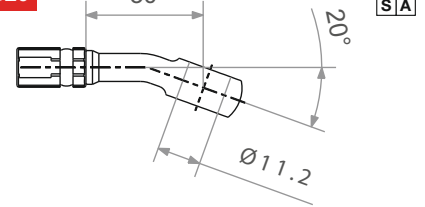

MV 10B30

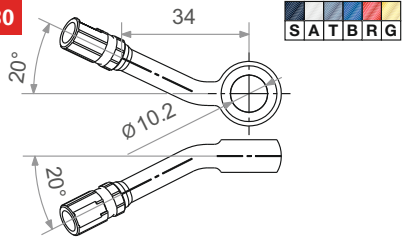

MV 10B40

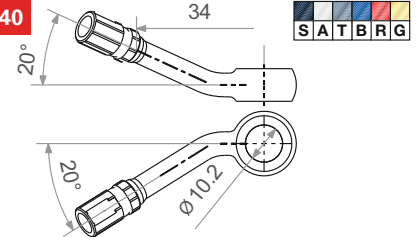

MV 10E20

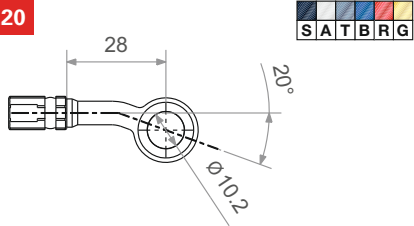

MV 10C45

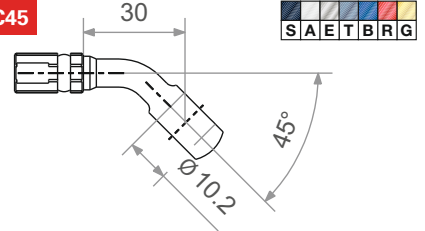

MV 11C45

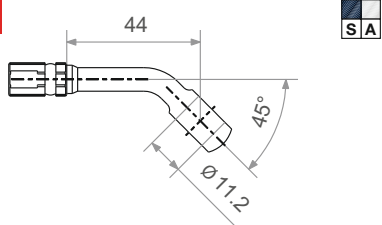

MV 10D50

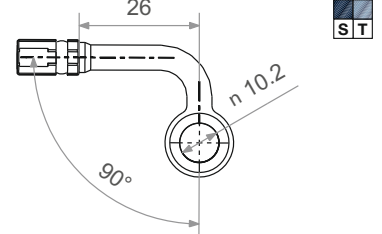

MV 10D90

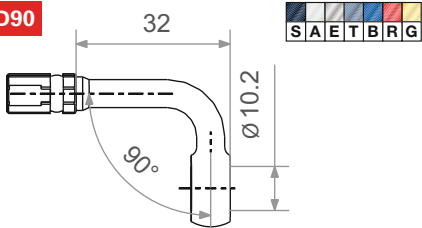

MV 11D90

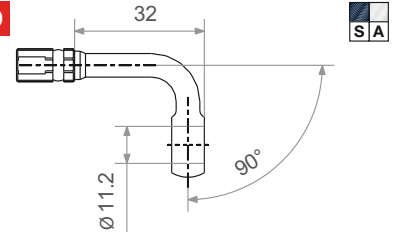

MV 10K00

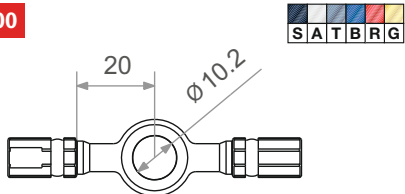

MV 10KA1

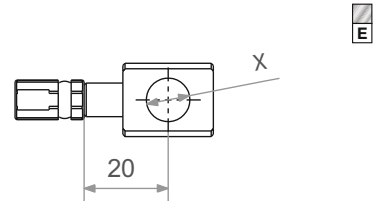

- S = Schwarz, black, noire
- A = Aluminium, aluminium
- E = Edelstahl, stainless steel, inox
- T = Titan, titanium, titane
- B = Blau, blue, bleu
- R = Rot, red, rouge
- G = Gold, gold, aurifère

MVF 100

M10x1.00

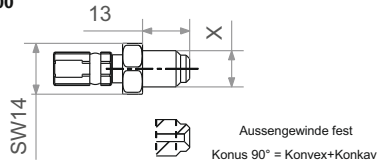
**MVF 225**

M10x1.25

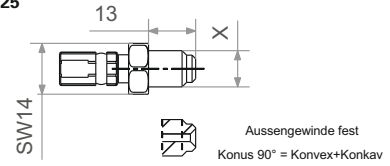
**MVF 400**

M10x1.00

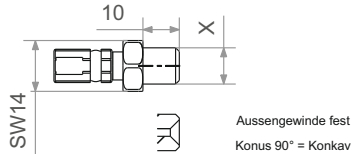
**MVF 900**

M10x1.00

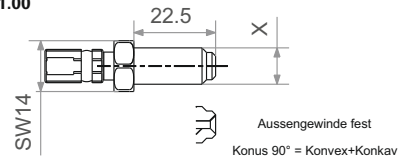
**MVG 100**

M10x1.00

MVG 225

M10x1.25

MVG 38

3/8"-24 UNF

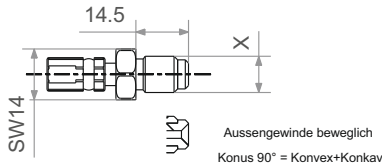
**MVH 100**

M10x1.00

MVH 225

M10x1.25

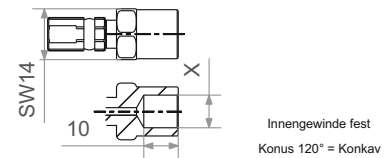
**MVH 400**

M10x1.00

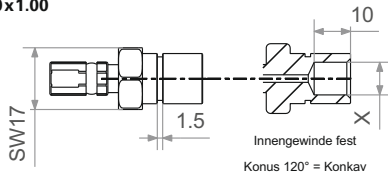

Zur Komplettierung der Bremsleitung bitte Anschlüsse separat bestellen, hinter der Art.-Nr. den Farbcode angeben!

To complete the brake line, please order connectors separately, put the colour code behind the art.-N°!

Pour réaliser un kit durite, merci de commander les raccords au-dessus!

MVJ 100

M10x1.00

MVJ 225

M10x1.25

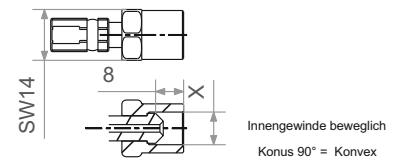
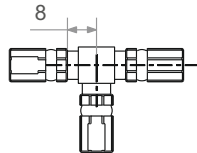
**MV 988**

3-Weg Verteiler

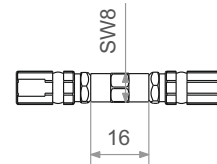
MV 989

Kupplung Vario

Dichtringe:**MCH 991 W20** (Ø 10 mm, 20 Stück)**MCH 991 W50** (Ø 10 mm, 50 Stück)

für Harley Davidson:

MCH 990 W10 (Ø 11,2 mm, 10 Stück)**Aluminium washers:****MCH 991 W20** (Ø 10 mm, 20 pcs.)**MCH 991 W50** (Ø 10 mm, 50 pcs.)

for Harley Davidson:

MCH 990 W10 (Ø 11,2 mm, 10 pcs.)**Joints aluminium:****MCH 991 W20** (Ø 10 mm, 20 pièces)**MCH 991 W50** (Ø 10 mm, 50 pièces)

pour Harley Davidson:

MCH 990 W10 (Ø 11.2 mm, 10 pièces)**Bestellbeispiel Varioflex:**

Bremsleitung 21 cm (transparent):

MV 021 T

Bremsleitung 115 cm (schwarz):

MV 115 S

Ringanschluss gerade (titan):

MV 10A00 T

Ringanschluss 90° (schwarz):

MV 10D90 S**Ordering example:**

brake line 21 cm (clear covering):

MV 021 T

brake line 115 cm (black):

MV 115 S

straight banjo (titanium):

MV 10A00 T

90° banjo (black):

MV 10D90 S**Exemple de commande:**

longueur de durite 21 cm (transp.):

MV 021 T

longueur de durite 115 cm (noire):

MV 115 S

raccord droit (titane):

MV 10A00 T

raccord 90° (noire):

MV 10D90 S